

Lancaster County
Land of John Stone

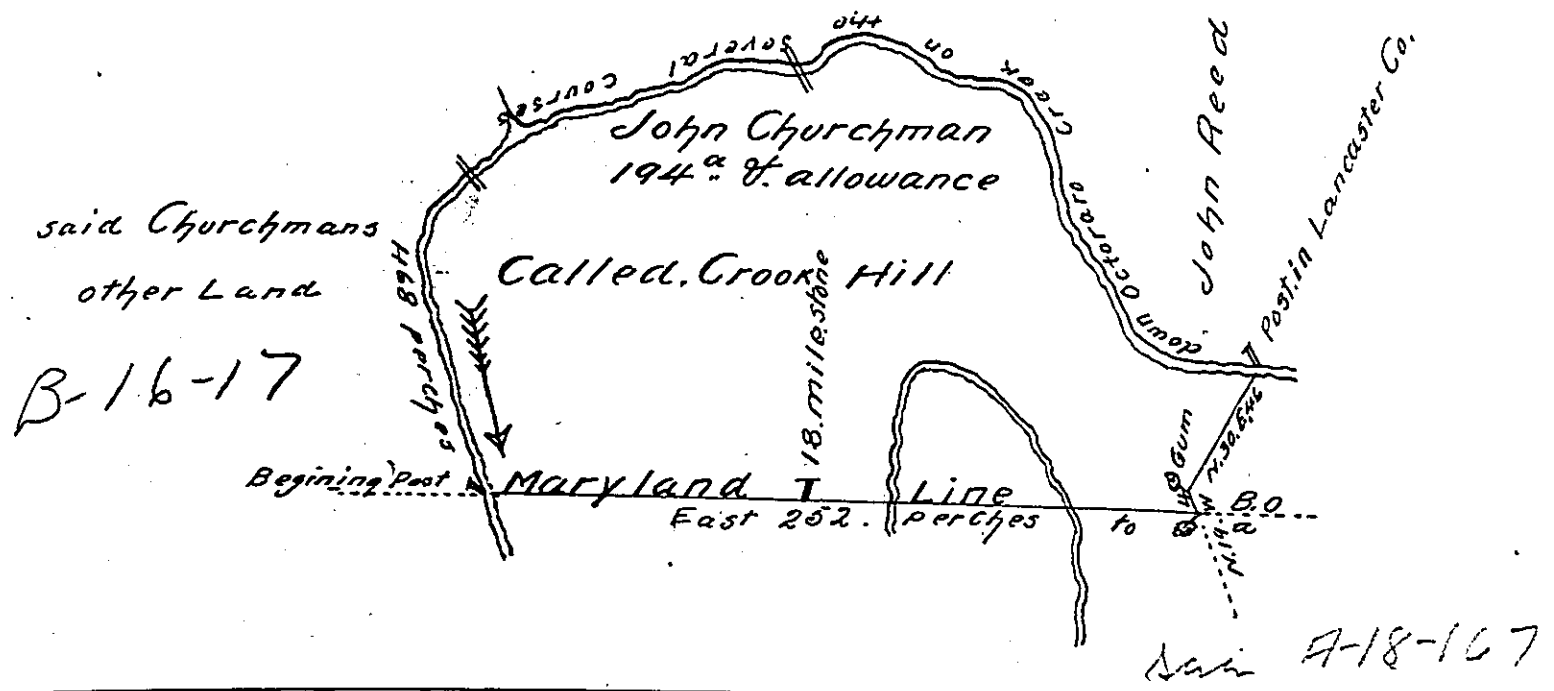

By Virtue of a Warrant bearing date the 29th day of June 1786 Surveyed to John Churchman the Tract of Land above described Beginning at a post on the West side of Octoraro Creek standing in the Line of Maryland & at the corner of Lancaster County & running thence East two hundred & fifty two perches to a Black Oak thence North nineteen degrees West four perches to a Gum thence North thirty degrees East forty six perches to a post on the North side of Octoraro & in the County of Lancaster thence down the Lancaster County side of Octoraro Creek (which is the line of Chester County also) on the several courses thereof four hundred & sixty eight perches to the beginning Containing one hundred & ninety four acres of Land besides the allowance of six p Cent. the greatest part of which is situate in the County of Chester Surveyed & Certified p

J. Churchman

To John Lukens Esqr.
Surveyor General

IN TESTIMONY that the above is a copy of the original remaining on file in the Department of Internal Affairs of Pennsylvania, made conformably to an Act of Assembly approved the 16th day of February, 1833, I have hereunto set my Hand and caused the Seal of said Department to be affixed at Harrisburg, this twenty-ninth day of March 1904

Isaac R. Pison
Secretary of Internal Affairs.